



DuraTrax LAVA WARNING TRACK

PART 1 – GENERAL

1.1 SUMMARY

- A. This section includes the material and labor requirements for construction of a complete warning track for the following items:
 - 1. DuraTrax Warning Track
- B. Related Sections
 - 1. Site Preparation
 - 2. Earthwork

1.2 SUBMITTALS

- A. Product Data: For the product specified, submit a 5-pound sample along with a private lab test result indicating the particle size analysis of the material specified. All tests shall be performed in accordance with ASTM F-1632.
- B. Approved Testing Lab: Turf & Soil Diagnostics
35 King Street
Trumansburg, NY 14886
607-387-5694

1.3 PROJECT/SITE CONDITIONS

- A. All site work and earthwork shall be performed in accordance with the preceding sections. Furthermore, the compacted subgrade shall be installed in accordance with the final slope and shall mirror finish grade in order to ensure an even depth of material once placement has occurred.

- B. In certain instances, and where warranted, a survey of the subgrade elevations shall occur prior to placement of the material.

1.4 QUALITY ASSURANCE

- A. **Installer Qualifications:** Installers of materials specified shall have, at minimum, five successful installations of similar projects and materials. Installers shall be in possession of and demonstrate knowledge of the use of laser guided finishing equipment.
- B. **Material:** If quality control samples are specified, they shall be completed at a rate of one per 250 tons of material delivered to the jobsite. All tests shall be conducted by the lab specified in Section 1.2 (B). All testing will be compared to and be in accordance with the material specifications provided in Section 2.2.

PART 2 – PRODUCT

2.1 MANUFACTURERS

- A. DuraTrax Warning Track is by the following manufacturer:

DuraEdge Products, Inc.
149 South Broad Street, Grove City, PA 16127
Phone: (866) 867-0052 Fax: (724) 530-6696
Email: info@duraedge.com Website: www.duraedge.com

2.2 MATERIALS

WARNING TRACK AGGREGATE GRADATION

- A. DuraTrax Lava Warning Track is an engineered product which is mechanically crushed and screened offsite in a controlled environment.

B. Performance Specification

1. Warning Track shall be clean, crushed reddish brown lava resulting in a mix that is reddish brown in color, having a yield of 1.15 tons per cubic yard and possessing the following particle size analysis:

| Sieve Designation | Range of % Passing |
|--------------------------|---------------------------|
| 3/16" | 100 |
| No. 4 | 90-100 |
| No. 8 | 60-80 |
| No. 16 | 45-60 |
| No. 30 | 30-50 |
| No. 50 | 20-35 |
| No. 100 | 10-25 |
| No. 200 | 5-15 |

Material meeting this specification would be DuraTrax Lava Warning Track as manufactured by DuraEdge Products, Inc. 866-867-0052, or an approved equal.

2.3 EXCESS MATERIALS

- A. Provide the owners' authorized representative with a 1-ton pallet of material for future use.

PART 3 – EXECUTION

3.1 PLACEMENT

- A. First, excavate material from the warning track area to a depth of 7 inches below the final finished grade.
- B. Compact the subgrade until 90 to 95 percent compaction is achieved
- C. Place 3 inches of 2A limestone on top of the subgrade, capped with 1 inch of limestone dust, for a total of 4 inches.
- D. Finally, place the warning track material over the top of the limestone dust. The depth of the warning track material should be 3 inches at completion after compaction.

- E. When placing both the limestone and the warning track material, use lifts of 2 inches and compact with a minimum 1-ton vibratory roller until an optimum compaction between 90 percent and 95 percent is achieved. Scarify the surface to facilitate bonding of the next lift and repeat until finish grade elevation is achieved. Completing this process as described will minimize settling and improve the performance of the product.
- F. The warning track and limestone layers beneath it must have a 1 percent slope toward the outfield fence. See schematic cross-section below in 3.1.H.

G.

Warning Track Cross-Section

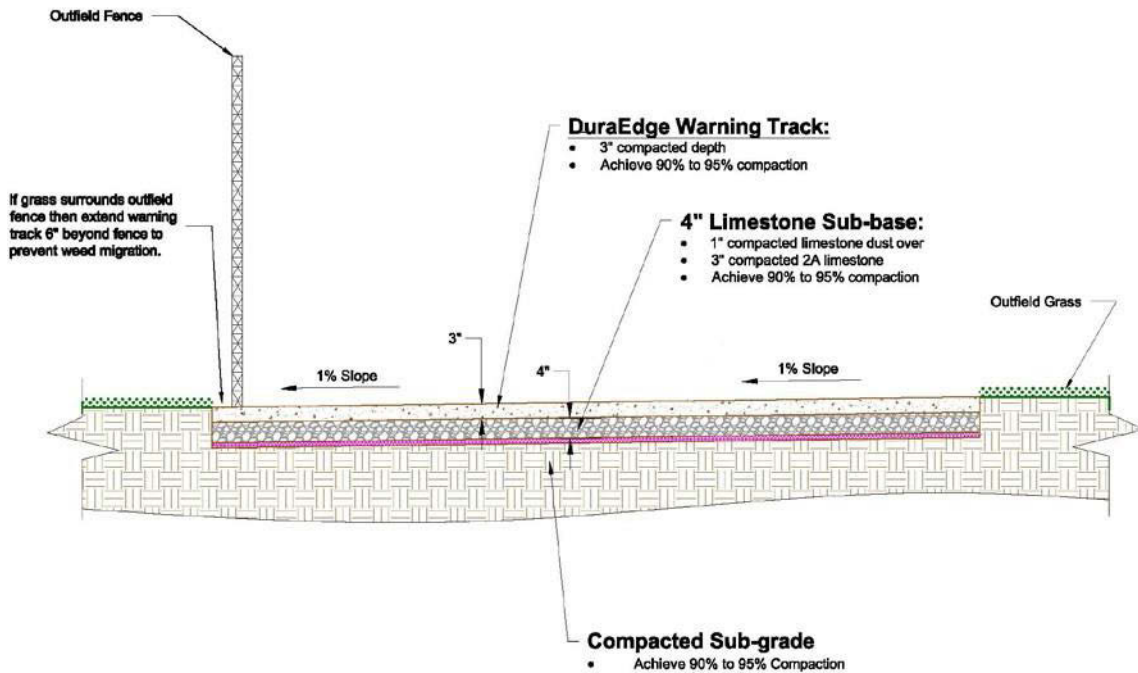

3.2 INSPECTION

- A. The finished surface of the warning track shall be smooth and free from any visible dips, humps, bumps or other blemishes which would hinder the removal of water through positive surface drainage. Where warranted, a finished elevation survey shall be conducted to assure proper installation.